

# GRAND PARK

## PLANNED DEVELOPMENT DISTRICT PLAN

LOCATED IN SECTIONS 20, 28, 29, 30, 31, 32  
TOWNSHIP 1 SOUTH, RANGE 75 WEST OF THE 6TH PM  
COUNTY OF GRAND, STATE OF COLORADO

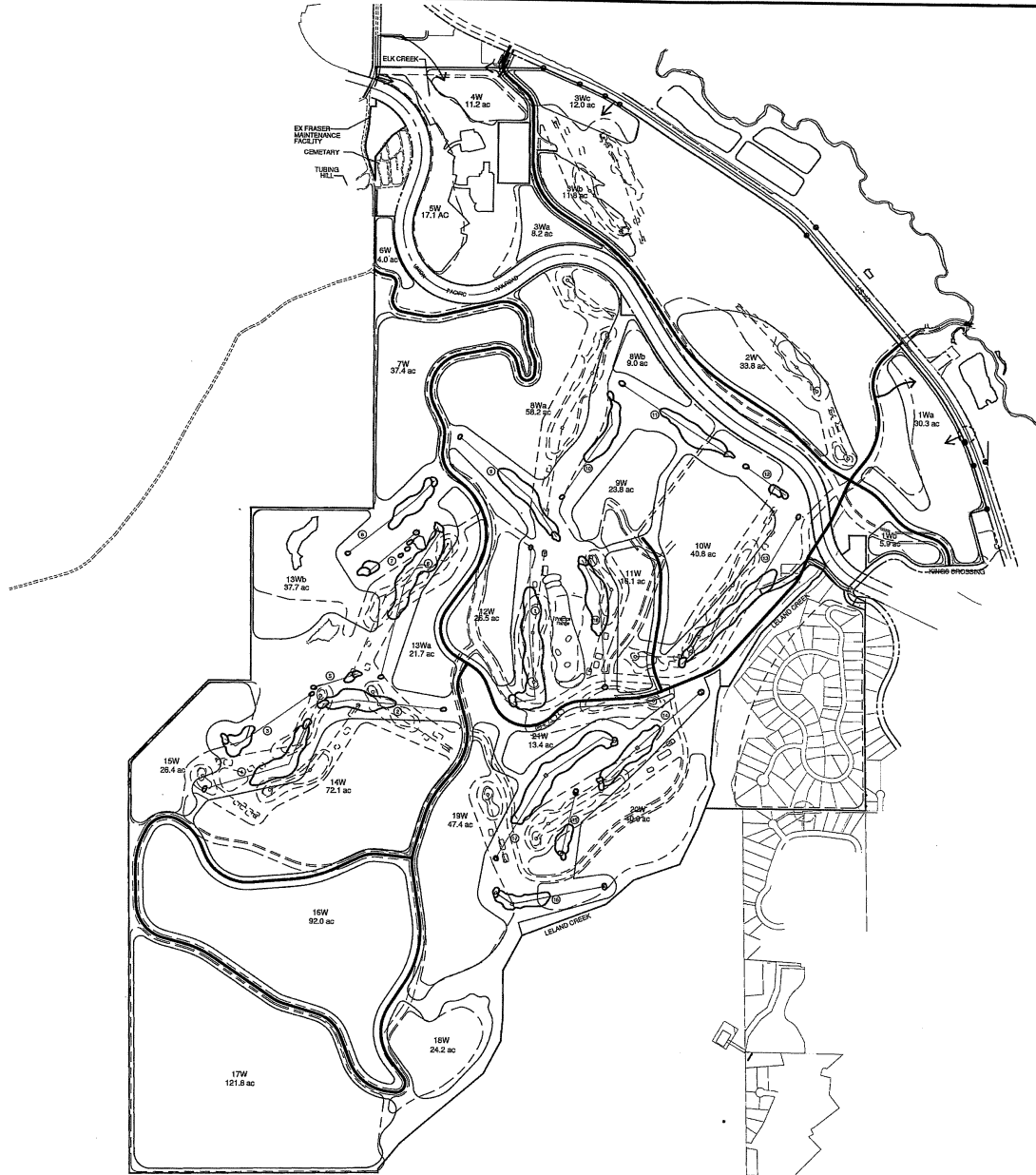

| Planning Area | Approved PDDP Planning Area Acreage | Proposed PDDP Planning Area Acreage | Approved PDDP Residential Units |          | Proposed PDDP Residential Units |          | Approved PDDP Lodging Units | Proposed PDDP Lodging Units | Approved PDDP Commercial Sq. Ft. | Proposed PDDP Commercial Sq. Ft. |
|---------------|-------------------------------------|-------------------------------------|---------------------------------|----------|---------------------------------|----------|-----------------------------|-----------------------------|----------------------------------|----------------------------------|
|               |                                     |                                     | detached                        | attached | detached                        | attached |                             |                             |                                  |                                  |
| 1Wb           | 33.6                                | 30.3                                |                                 | 230      |                                 | 250      | 300                         | 300                         | 150,000                          | 140,000                          |
| 1Wc           | 4.3                                 | 5.9                                 |                                 | 40       |                                 | 40       |                             |                             |                                  |                                  |
| 2W            | 25.1                                | 33.8                                |                                 | 250      | 150                             | 100      | 278                         | 278                         | 100,000                          | 30,000                           |
| 3W            | 11.2                                | 8.2                                 |                                 | 110      |                                 | 85       |                             |                             |                                  |                                  |
| 3Wb           | 5.4                                 | 11.8                                |                                 | 80       | 50                              | 30       |                             |                             |                                  |                                  |
| 3Wc           | 11.7                                | 12.0                                |                                 | 60       |                                 | 60       |                             |                             | 30,000                           | 70,000                           |
| 4W            | 8.5                                 | 11.2                                |                                 | 100      |                                 | 100      |                             |                             | 65,800                           | 105,800                          |
| 5W            | 16.9                                | 17.1                                |                                 | 100      | 70                              | 30       |                             |                             |                                  |                                  |
| 6W            | 4.0                                 | 4.0                                 |                                 |          |                                 |          |                             |                             |                                  |                                  |
| 7W            | 88.8                                | 37.4                                | 45                              | 225      | 50                              | 30       |                             |                             |                                  |                                  |
| 8W            | 50.1                                | n/a                                 | 63                              | 75       |                                 |          |                             |                             | public site                      | public site                      |
| 9W            | n/a                                 | 58.2                                |                                 |          | 83                              | 110      |                             |                             |                                  |                                  |
| 9Wb           | n/a                                 | 8.0                                 |                                 |          |                                 | 40       |                             |                             |                                  |                                  |
| 9Wc           | 45.5                                | 23.8                                |                                 | 153      | 33                              | 73       |                             |                             |                                  |                                  |
| 10W           | 42.8                                | 40.8                                |                                 | 118      | 40                              | 134      |                             |                             |                                  |                                  |
| 11W           | 9.7                                 | 16.1                                | 10                              | 24       | 10                              | 31       | 200                         | 200                         | 20,000                           | 20,000                           |
| 12W           | 15.8                                | 28.5                                |                                 | 92       |                                 | 92       | 350                         | 350                         | 30,000                           | 30,000                           |
| 13W           | 31.1                                | n/a                                 | 50                              |          |                                 |          | 150                         | 50                          |                                  |                                  |
| 13Wb          | n/a                                 | 21.7                                |                                 |          | 40                              |          |                             | 100                         |                                  |                                  |
| 13Wc          | n/a                                 | 37.7                                |                                 |          | 40                              |          |                             |                             |                                  |                                  |
| 14W           | 49.8                                | 72.1                                | 117                             |          |                                 | 117      |                             |                             |                                  |                                  |
| 15W           | 26.1                                | 28.4                                | 12                              |          |                                 | 12       |                             |                             |                                  |                                  |
| 16W           | 102.5                               | 92.0                                | 90                              |          |                                 | 90       |                             |                             |                                  |                                  |
| 17W           | 120.0                               | 131.5                               | 72                              |          |                                 | 120      |                             |                             |                                  |                                  |
| 18W           | n/a                                 | 24.2                                |                                 |          |                                 | 61       |                             |                             |                                  |                                  |
| 18Wb          | 23.2                                | n/a                                 | 14                              |          |                                 |          |                             |                             |                                  |                                  |
| 18Wc          | 42.1                                | n/a                                 | 47                              |          |                                 |          |                             |                             |                                  |                                  |
| 19W           | 35.8                                | 47.4                                | 88                              | 83       | 40                              | 70       |                             |                             |                                  |                                  |
| 20W           | 12.5                                | 40.0                                |                                 | 57       | 26                              | 56       |                             |                             |                                  |                                  |
| 21W           | 23.6                                | 13.4                                |                                 | 50       | 20                              | 30       |                             |                             |                                  |                                  |
| 21Wb          | n/a                                 | n/a                                 |                                 |          |                                 |          |                             |                             |                                  |                                  |
| 21Wc          | n/a                                 | n/a                                 |                                 |          |                                 |          |                             |                             |                                  |                                  |
| 22W           | 80.1                                | n/a                                 | 80                              |          |                                 |          |                             |                             |                                  |                                  |
| subtotal      | 919.7                               | 842.8                               | 886.0                           | 1857.0   | 1052                            | 1411     |                             |                             |                                  |                                  |
| 22W           | 455.9                               | 465.1                               |                                 |          |                                 |          |                             |                             |                                  |                                  |
| TOTAL         | 1386.6                              | 1510.9                              | 2543.0                          |          | 2463.0                          |          | 1278                        | 1278                        | 385,800                          | 395,800                          |

--- APPROVED PDDP  
 --- PROPOSED PDDP

2005-012709

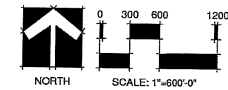

AN AMENDMENT OF THE RENDEZVOUS 2003  
 PLANNED DEVELOPMENT DISTRICT PLAN

DATE: JUNE 16, 2005

STATE OF COLORADO ) SS  
 County of GRAND )  
 Filed for record this 8  
 day of June 2005  
 at 4:07 p.m. in Book 214  
 Record in Book \_\_\_\_\_ Page \_\_\_\_\_  
 SARAL ROSEINE  
 Deputy  
 Fees \$ 111

PLANNING AREA  
 COMPARISON

SHEET 5 OF 11